

trogotronic »m« 676™

Save yourself from injury & your 676 from damage!
Use caution & always act in accordance to these instructions:

ALWAYS REMOVE POWER WHEN MODULE IS UNATTENDED!
"INSIDE" OF MODULE HAS MANY SHARP EDGES & MAY CUT UNPROTECTED HANDS; **HANDLE WITH CARE.**

THE MODULE MUST **NEVER BE POWERED WITHOUT INSTALLATION** IN AN APPROPRIATE ENCLOSURE; **UNWARRANTED DAMAGE TO 676 & MORTAL INJURY MAY RESULT.**

TO AVOID SHOCK HAZARD **ALWAYS WAIT 30 MINUTES AFTER REMOVING POWER BEFORE REMOVING MODULE FROM ENCLOSURE**

- 1 » INSTALL 676 module in your enclosure carefully.
- 2 » TURN DOWN VOLUME twist to the left/counter clock wise.
- 3 » PATCH output jack to mixer, amplifier, module etc.
- 4 » ATTACH power supply 2.1mm male Jack to 676 (front or rear).
- 5 » PLUG IN POWER SUPPLY to main power source.
- 6 » WARM UP full 15 seconds before carefully adjusting VOLUME.
- 7 » ALWAYS UNPLUG the power supply when unattended.

* Get the MOST LIFE out of your TUBE: ALWAYS REMOVE POWER WHEN MODULE IS UNATTENDED!

Questions? 1-562-472-0672 or info@trogotronic.com
More contact info at www.trogotronic.com

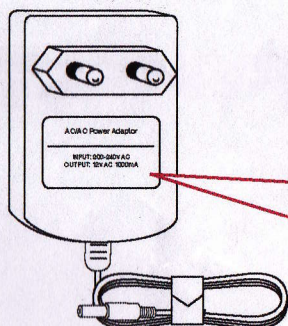

MODULE USES
12v AC/AC POWER
SUPPLY OF 850mA
OR GREATER
NEVER USE AN AC/DC
POWER SUPPLY WITH THIS
INSTRUMENT, COSTLY
DAMAGE OR EVEN FIRE
MAY RESULT!

CAUTION: SHOCK HAZARD ON ENTIRE REAR OF MODULE AVOID CONTACT UNTIL 30 MINUTES AFTER REMOVING POWER!
NEVER POWER UP 676 WHEN MODULE IS NOT COMPLETELY MOUNTED IN ENCLOSURE!

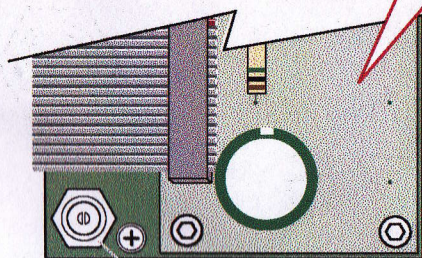

VOLUME ATTENUATOR Start low & add more level as needed.

ATTENTION: 676 FURY IS A HIGH OUTPUT DEVICE!
VOLTAGE OVERLOAD COULD CAUSE DAMAGE TO YOUR OTHER VALUABLE EQUIPMENT! Avoid exceeding the input amplitude specifications of your audio gear by using the 676's VOLUME knob with caution and common sense.

TRACK Electronic whammy bar. *CV kicks in > +8v

DRIVE Go-to effect of overall sound w/ rich thresholds. *CV

INDICATOR LAMPS seen behind vacuum tube.

MODULATOR modulate/squash/expand overall sound. *CV

OSC 2 Sets frequency. *CV

OSC 1 Sets frequency. *CV



HANDMADE IN USA

STABILIZERS Stabilizer section allows the instrument to be used in multiple manners; Rule of thumb is up = stability, down = anarchy.

RECTIFY SWITCH on=smooths osc. control signal.

THRUST SWITCH on=amplifies osc. control signal.

SYNCH SWITCH on=distills osc. control signal.

CV INPUT/OSCILLATOR 2 (0 to +12v) *attenuated by OSC 2 knob.

CV INPUT/OSCILLATOR 1 (0 to +12v) *attenuated by OSC 1 knob.

LINE LEVEL AUDIO INPUT effects/triggers/filters/modulates circuit
VOLTAGE OVERLOAD OF LINE LEVEL AUDIO INPUT COULD CAUSE DAMAGE YOUR MODULE! Do not exceed -6v to +6v amplitude.

AUDIO OUTPUT

ATTENTION: 676 FURY IS A HIGH OUTPUT DEVICE!
VOLTAGE OVERLOAD COULD CAUSE DAMAGE TO YOUR OTHER VALUABLE EQUIPMENT! USE VOLUME KNOB TO ATTENUATE!

CV INPUT/TRACK KB (+8 to +12v) *attenuated by TRACK knob.

CV INPUT/DRIVE KB (0 to +12v) *attenuated by DRIVE knob.

CV INPUT/MOD KB (0 to +12v) *attenuated by MOD knob.

POWER JACKS (use either front & back) 12v/AC/850ma

ATTENTION: AVOID DAMAGE TO YOUR MODULE; DO NOT OVERTIGHTEN THESE MOUNTING SCREWS WITH THE INCLUDED 2.5mm HEX TOOL!

